

LAMORINDA'S LEADING INDEPENDENT REAL ESTATE FIRM

ORINDA



160/162 Camino Don Miguel
6 bd/6.5 ba Spanish Revival estate w/ views of OCC golf course and hills beyond. Exceptional location!
\$6,395,000

ORINDA



121 Van Ripper Lane
1st time ever for sale! Stunning totally renovated 5+ Bd Sleepy Hollow estate on glorious 1+ acre!
\$4,500,000

ORINDA



8 Tappan Court
Completely renovated 5 bd/ 4 ba home on an unparalleled level .82 acre knoll parcel!
\$3,595,000

ORINDA



5 De Soto Court
Mid Century Contemporary 4 bd/ 2.5 ba offers peaceful private setting on quaint court minutes from downtown!
\$2,395,000

ORINDA



11 Los Altos Road
Special 4 bd/ 4 ba home sits on .70 parcel w/ privacy & filtered views in Orindas most popular neighborhood!
\$2,295,000

ORINDA



40 Via Floreado
Charming 5 bd/ 3.5 ba gem is full of old-world features yet perfectly updated w/ all the modern amenities!
\$1,995,000

ORINDA

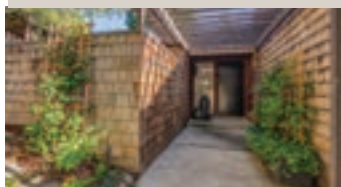

120 Ravenhill Road
Completely renovated 3 bd/ 3 ba Orindawoods home offers an ideal setting w/ natural light, privacy & views!
\$1,795,000

ORINDA



589 Tahos Road
Tucked in the hills of Orinda amongst mature oaks, sits this 4 bd/2.5 ba architecturally significant Mid-Century retreat!
\$1,675,000

ORINDA



2 Orchard Court
Home sweet home! 3 bd/ 2 ba home needs lots of TLC now & is awaiting the next generation!
\$1,195,000

ORINDA

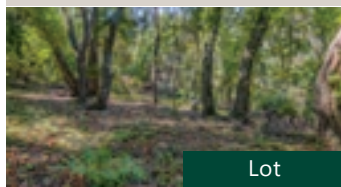

0 Camino Del Monte
Come see this desirable lot located minutes from Hwy 24/BART, top rated schools, downtown, regional parks & views!
\$225,000

LAFAYETTE



1336 San Reliez Court
Rare opportunity on .75 acre lot w/ 5 bd/ 3.5 ba 4098 sq.ft. in the heart of Springhill!
\$2,195,000

LAFAYETTE



3015 Bradbury Drive
Nestled among majestic oaks 3 bd/ 2.5 ba plus loft sits on 3.2 acres w/ panoramic views, multiple decks & pool!
\$1,895,000

MORAGA



92 Warfield Drive
Classic two story 5 bd/ 3 ba home sits on a private .39 acre parcel w/ 2527 sq.ft of a fully functional floor plan!
\$1,945,000

BERKELEY



7164 Buckingham Blvd
Sophisticated contemporary 3 bd/ 3 ba set in the Claremont Hills featuring lovely canyon views!
\$1,595,000

DANVILLE



501 Garden Creek Place
Updated 3 bd/ 2.5 ba end-unit townhome less than .5 miles from top-rated schools, downtown & more!
\$899,000

GRASS VALLEY



16056 Mount Olive Road
Traditional 3 bd/ 3 ba ranch style home set on 1.97 acres, 1248 sqft w/ detached 'studio-like' structure of approx. 320 sqft!
\$525,000

The Village Associates:

Ashley Battersby
Patricia Battersby
Shannon Conner
Meara Dunsmore

Linda Ehrich
Emily Estrada

Joan Evans

Linda Friedman

Liz Gallagher

Claudia Gohler

Gillian Judge Hogan

Dexter Honens II

Christina Linezo

April Matthews

Hillary Murphy

Karen Murphy

John Nash

Altie Schmitt

Judy Schoenrock

Ann Sharf

Amy Rose Smith

Molly Smith

Jeff Snell

Lynda Snell

Clark Thompson

Angie Evans Traxinger

Ignacio Vega

Ann Ward

Margaret Zucker

facebook.com/VillageAssociates
 twitter.com/villageassoc
 instagram.com/VillageAssociates

93 Moraga Way, Suite 103 • Orinda, CA 94563 • Phone: (925) 254-0505

Visit www.villageassociates.com

Sunday Open Homes

Village
ASSOCIATES

It's Village. Of Course.

DRE#01301392